

DH-NVR7408/7416/7432/7464

8/16/32/64CH 1.5U Network Video Recorder



Features

- > Up to 8/16/32/64 channel with 1080P realtime live view
- > H.264/MJPEG dual codec decoding
- > Max 256Mbps incoming bandwidth
- > HDMI/VGA/TV simultaneous video output
- > 8/16/32 channel synchronous realtime preview, GRID interface
- > Support Multi-brand network cameras: Dahua, Arecont Vision, AXIS, Bosch, Brickcom, Canon, CP Plus, Dynacolor, Honeywell, Panasonic, Pelco, Samsung, Sanyo, Sony, Videosec, Vivotek and etc.
- > ONVIF Version 2.3 conformance
- > 3D intelligent positioning with Dahua PTZ camera
- > Support 4 SATA HDDs up to 16TB, 1 eSATA up to 16TB, 3 USB2.0
- > Multiple network monitoring: Web viewer, CMS(DSS/PSS) & DMSS

DH-NVR7408/7416/7432/7464

Technical Specifications

Model	DH-NVR7408	DH-NVR7416	DH-NVR7432	DH-NVR7464
System				
Main Processor	Dual-core embedded processor			
Operating System	Embedded LINUX			
Video & Audio				
IP Camera Input	8 channel	16 channel	32 channel	64 channel
Two-way Talk	1 channel Input, 1 channel Output, BNC			
Display				
Interface	1 HDMI, 1 VGA, 1 TV			
Resolution	1920×1080, 1280×1024, 1280×720, 1024×768 & etc.			
Display Split	1/4/8/9	1/4/8/9/16	1/4/8/9/16/25/36	1/4/8/9/16/25/36
OSD	Camera title, Time, Video loss, Camera lock, Motion detection, Recording			
Recording				
Compression	H.264/MJPEG			
Resolution	1080p(1920×1080) / 720p(1280×720) / D1(704×576/704×480) & etc.			
Record Rate	192Mbps			
Bit Rate	48~ 8192kbps			
Record Mode	Manual, Schedule(Regular(Continuous), MD, Alarm), Stop			
Record Interval	1~120 min (default: 60 min), Pre-record: 1~30 sec, Post-record: 10~300 sec			
Video Detection & Alarm				
Trigger Events	Recording, PTZ, Tour, Alarm, Video Push, Email, FTP, Buzzer & Screen tips			
Video Detection	Motion Detection, MD Zones: 396(22×18), Video Loss & Camera Blank			
Alarm Input	8 channel	16 channel	16 channel	16 channel
Relay Output	3 channel	6 channel	6 channel	6 channel
Playback & Backup				
Sync Playback	1/4/9	1/4/9/16	1/4/9/16	1/4/9/16
Search Mode	Time/Date, Alarm, MD & Exact search (accurate to second), Smart search			
Playback Function	Play, Pause, Stop, Rewind, Fast play, Slow play, Next file, Previous file, Next camera, Previous camera, Full screen, Repeat, Shuffle, Backup selection, Digital zoom			
Backup Mode	USB Device/eSATA Device/Internal SATA burner/Network			
Network				
Ethernet	2 RJ-45 ports (10/100/1000Mbps)			
Network Function	HTTP, TCP/IP, IPv4/IPv6, UPNP, RTSP, UDP, SMTP, NTP, DHCP, DNS, IP Filter, PPPOE, DDNS, FTP, Alarm Server, IP Search(Support Dahua IP camera, DVR, NVS and etc.)			
Max. User	128 users			

DH-NVR7408/7416/7432/7464

Access	
Smart Phone	iPhone, iPad, Android, Windows Phone
Storage	
Internal HDD	4 SATA ports (4HDDs or 3HDDs+1CD/DVD-RW), up to 16TB
External HDD	1 eSATA port
Auxiliary Interface	
USB	3 ports (2 Rear), USB2.0
RS232	1 port, For PC communication & Keyboard
RS485	1 port, For PTZ control
General	
Power Supply	AC 100~240V, 50/60 Hz
Power Consumption	40W (without HDD)
Working Environment	-10°C~+55°C / 10%~90%RH / 86~106kpa
Dimension (W×D×H)	1.5U, 440mm×407mm×70mm
Weight	5kg (without HDD)

System Connection

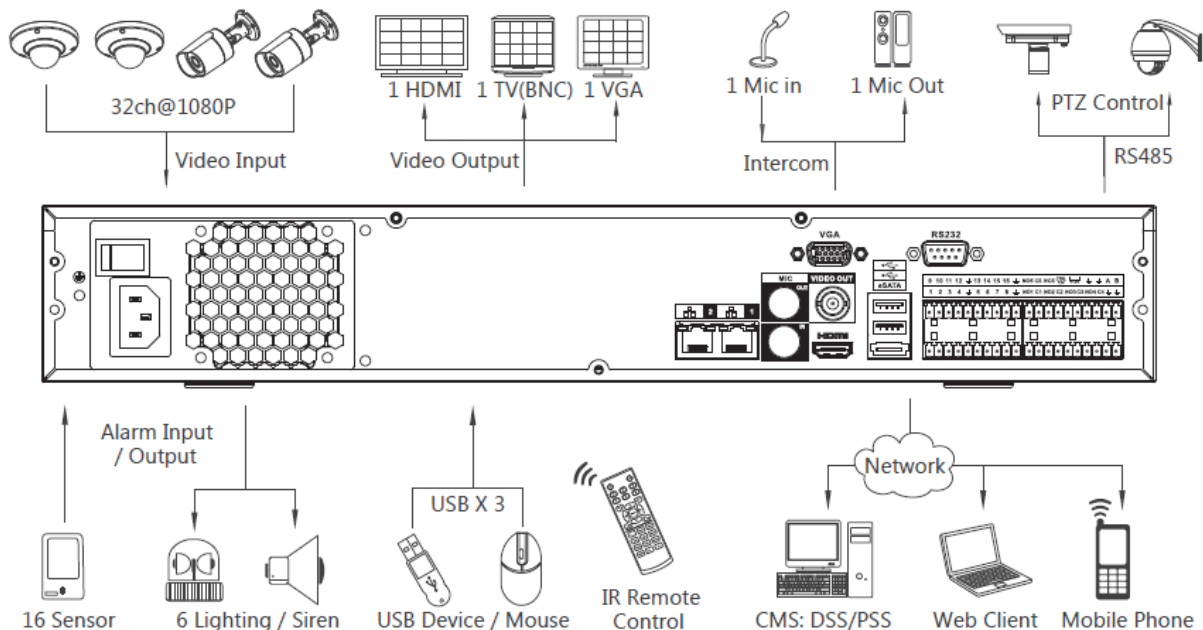

* Takes NVR7432 as an example

DH-NVR7408/7416/7432/7464

Dahua Technology Co., Ltd. 1187BinAn Road, Binjiang District, Hangzhou, China

Tel: 66956096-09126017817-09107616575

email:imensazaa@gmail.com

www.irandahua.com